



ISO Compact Pneumatic Cylinders



Features

- Space saving, compact and light weight design
- Dimensions as per ISO 21287
- Low friction, long life seals
- Large clamping force in relation to size
- Standard t-slot for magnetic reed switch
- Magnetic sensor common for all sizes
- Options: Male and female piston rod threading, foot and flange mountings, viton seals
- Specials: Single-acting and double ended
- Available mountings to suit leading international brands

Available types

Single-Ended



Double-Ended

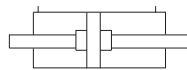

Single-Acting



Reed Switch Connect Diagram

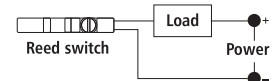

Specifications

Bore Sizes	16, 20, 25, 32, 40, 50, 63, 80, 100 mm
Medium	Compressed air (filtered and lubricated)
Design	Piston cylinder with cushion pad, magnetic and non magnetic version
Pressure range	7 to 150 psi (0.5 to 10 bar)
Temperature range	5 °C to 60 °C, up to 150 °C with viton seals (optional)
Material	End covers and piston- aluminium, Tube- square profile aluminium anodised, Piston rod- EN-8 hard chrome plated, Mountings: mild steel, Seals- NBR, polyurethane

Ordering code

FPC | **C** | **A** | **K** | **2** | **40** | **C** | **20** | **X** | **X** | **X**

C Series | Pressure | Mountings | Cushion pad | Ram size | Stroke | Type 1 | Type 2 | Type 3

Mountings	
A	Front flange
B	Rear flange
G	Foot
K	Basic

Cushion pad	
2	Cushion pad

Ram size	
A	8
B	10
C	12
D	16
F	20

Bore size	
16	50
20	63
25	80
32	100
40	

Type 1		Type 2		Type 3	
X	Standard	X	Std. (metric)	X	Standard
2	Double-ended	3	Female metric	9	Rod extension
5	Single-acting			M	Piston with magnet
6	Reed switch			0	Special

• Reed switch to be ordered separately, Part no. EP-39R-25M

Dimensions

(All dimensions in mm)

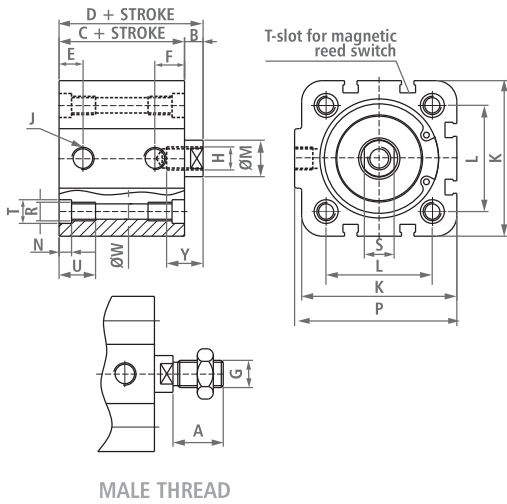

Bore	25	32	40	50	63	80	100
A	16	19	19	22	22	28	28
B	6	7	7	8	8	10	10
C	39	44	45	45	49	54	67
D	45	51	52	53	57	64	77
E	10	12	12	12	14	16	20
F	10	13	13	13	14	15.5	20
G	M8x1.25	M10x1.25	M10x1.25	M12x1.25	M12x1.25	M16x1.5	M16x1.5
H	M6x1	M8x1.25	M8x1.25	M10x1.5	M10x1.5	M12x1.75	M12x1.75
J	M5	G 1/8	G 1/8	G 1/8	G 1/8	G 1/8	G 1/8
K	40.5	45	60	68	80	98	114.5
L	26	32.5	38	46.5	56.5	72	89
M	10	12	12	16	16	20	20
N	5.0	5.5	5.5	5.5	5.5	5.5	5.5
P	43	49.5	62.5	71	88	104.5	123.5
R	M5	M6	M6	M8	M8	M10	M10
S	9	10	10	13	13	17	17
T	7.5	9	9	11	11	14	14
U	15	15	15	16	16	17	17
W	4.2	5.1	5.1	6.5	6.5	8.5	8.5
Y	10	12	12	16	16	20	20

* Stroke length offered up to max. 75 mm for all bore sizes

Bore \varnothing 25 mm

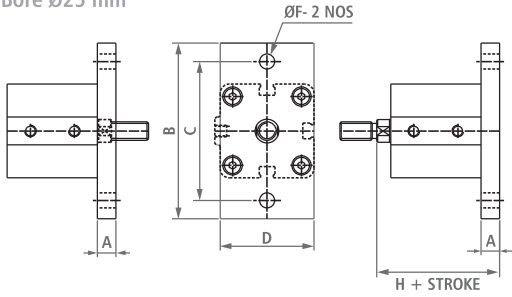

Front and rear flange mounting

Bore	25	32	40	50	63	80	100
A	8	10	10	12	12	16	16
B	76	80	90	110	125	155	185
C	60	64	72	90	100	126	150
D	40	50	55	68	78	100	120
E	-	32	36	45	50	63	75
F	6.5	7	9	9	9	12	14
H	53	61	62	65	69	80	93

Bore \varnothing 32-100 mm

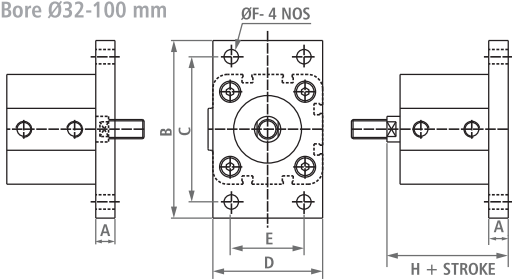

Foot mounting

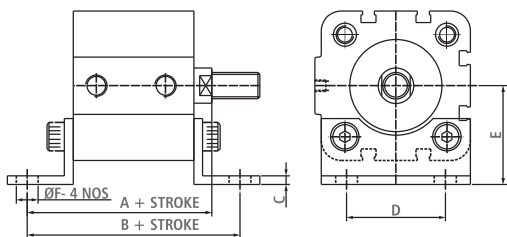

Bore	25	32	40	50	63	80	100
A	61	67	70	74	78	90	104
B	71	76	81	87	91	106	121
C	4	4	4	5	5	6	6
D	26	32	36	45	50	63	75
E	29	33.5	38	45	50	63	74
F	7	7	10	10	10	12	15

• For complete details, refer Product Data Sheet.